



Dial Indicator, Lug Back  
20mm, 0,01mm  
Item number: 2050S



Description

This is a standard, metric dial indicator. It offers you the following benefits:

- Bezel clamp and lifting lever (optional) can be attached to either right or left side. They can be easily installed and removed without tools.
- No through screw holes on the frame and secure adhesion between the bezel and the crystal as well as the use of an O-ring prevents water or oil penetration.

Specification

Range:	20 mm
Range per rev.:	1 mm
Graduation:	0.01 mm
MPE any 1/10 revolution:	6 µm
MPE any 1/2 revolution:	10 µm
MPE any 1 revolution:	11 µm
H MPE (Hysteresis):	4 µm
Mass:	149 g
R MPE (Repeatability):	3 µm
Scale:	0-100 (100-0)
C:	57 mm
D:	17.7 mm
Mass lug/plain:	149/140 g
E:	20 mm
F:	16.9 mm
G:	29.8 mm
I:	7.6 mm
Stem:	8 mm
Contact point:	Carbide tipped, thread: M 2.5 x 0.45 mm
Delivered:	with certificate of inspection, limit indicators
Digital/Analog:	Analog
Inch-Metric:	Metric
fu:	4 µm

Dimensions

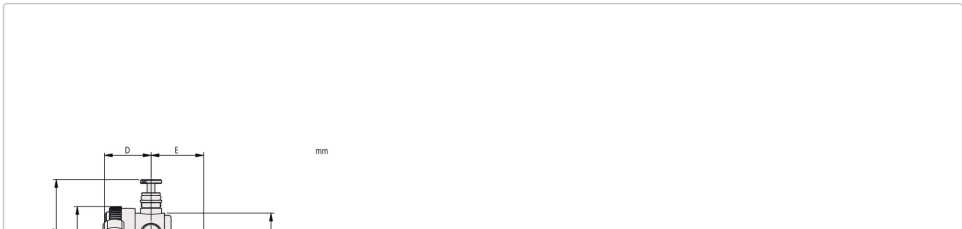

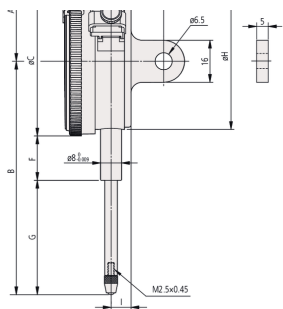

## Spare parts

### Consumable spares:



**Contact Element Ball Point**  
**7,3mm Length, Carbide, Metric**  
**901312**



**Contact Element Ball Point**  
**19,3mm Length, Waterproof Type, Metric**  
**21AZA321**



**NBR Rubber Boot**  
**IP64 Series 2**  
**136071**